

**THIRD FLOOR PLAN
APPLE ANNEX**

Constitution Avenue

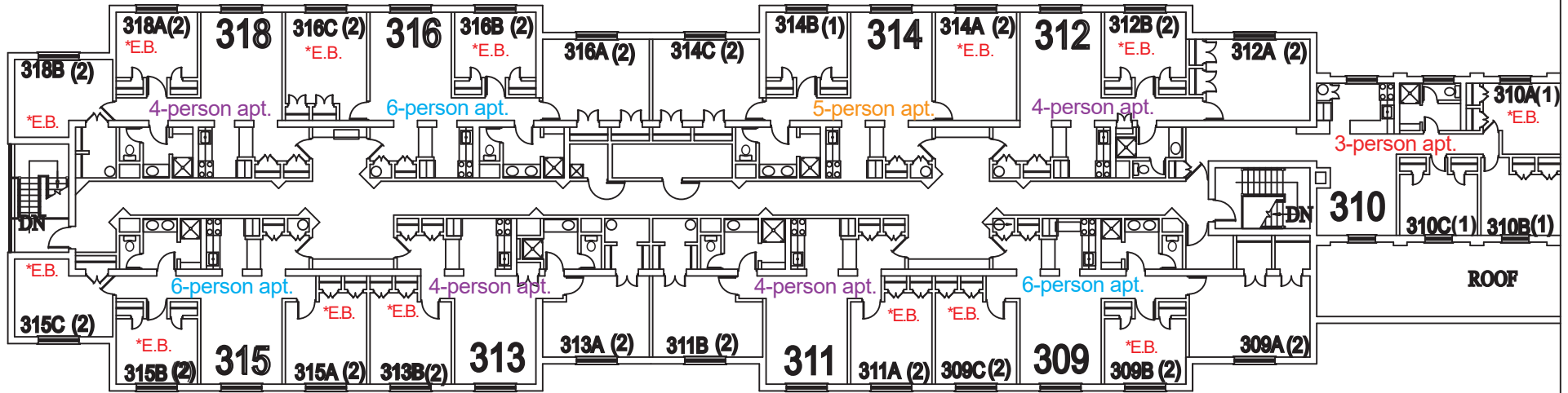

*E.B.- In the summer of 2008, Gettysburg College purchased custom furniture for Apple Hall in order to maximize space so that all bedroom furniture can be accommodated in each room. Due to the size of some rooms it is necessary or recommended that one or two of the beds be elevated either to a half height setting using a "junior loft" bed set or full height using a regular bed set. Please take this information into consideration when selecting a room if you prefer to have a bed set at the lowest level.